

LOYBT-TEMP1

Datasheet #89086602



The LOYBT-TEMP1 Bluetooth sensor is a battery powered sensor for measurements of room temperature and relative humidity. It acts as a low-power node in a Bluetooth mesh network and publishes sensor data on change of value as well as periodically.

The device allows to perform measurements at the location of your choice and after adding the sensor to the LPAD-7 the sensor data is automatically mapped to the system registers room temperature and humidity.

Device wake up can be forced by press of the service button. Dependent on the device status the device tries to join a Bluetooth mesh network, find a friend which allows the device to operate as low power node or simply transmits sensor data.

A service button press is always acknowledged by status LED blinking, the LED is also used to indicate power-up and firmware update procedure.

Features

- Easy integration with Bluetooth Mesh enabled LOYTEC devices (e.g. LPAD-7)
- Bluetooth-mesh based sensor, supports low power node feature
- Temperature sensor
- Humidity sensor
- Battery powered, expected battery lifetime: 2 years
- Battery level reporting
- Supports firmware update
- Service Push Button for manual interaction
- LED for optical feedback

Specifications

| | |
|--------------------------------|---|
| Dimensions (mm) | 30 x 13 (Ø x H), DIM082 |
| Installation | Wall mounted (screw or adhesive tape) |
| Power supply | Battery powered (CR2032), expected battery life time: 2 years |
| Operating conditions | 0 °C to 50 °C, 10 – 90 % RH, noncondensing, degree of protection: IP20 |
| Interfaces | 1x Bluetooth Mesh (low power node) 1x Service Push Button 1x Led (optical feedback) |
| Bluetooth & RF-characteristics | Maximum output power: +4 dBm Frequency range: 2402-2480 MHz |
| Temperature Measurement | -5°C to 60°C, resolution 0.1°C, accuracy: ± 0.2° (0°C-70°C) |
| Relative Humidity Measurement | 0%-100%, resolution: 1% Accuracy: typ. ± 2.2% R.H. @25°C, 20%-80% R.H. typ. ± 4% R.H. @25°C, 0%-20% R.H. and 80%-100% R.H. |
| Sensor Data Update | Periodically: 5 minutes interval Change of Temperature Value: >0.5° since last publication |
| Bluetooth protocol conformance | Bluetooth 5.1 Declaration ID: D060851 contains qualified designs: 150092 (controller subsystem), 176697 (host subsystem) and 178269 (mesh profile subsystem) |
| For use with | Bluetooth Mesh enabled LOYTEC devices (e.g. LPAD-7) |

| Order number | Product description |
|--------------|--|
| LOYBT-TEMP1 | Bluetooth Mesh temperature sensor (5 pieces per package) |

Functions
 L-WEB, L-STUDIO
 L-ROC
 L-INX
 L-IOB
 Gateways
 LPAD-7, L-VIS, L-STAT
 L-DALI
 Routers, NIC
 Interfaces
 Accessories

Dimensions of the devices in mm and [inch]

DIM082 LOYBT-TEMP1

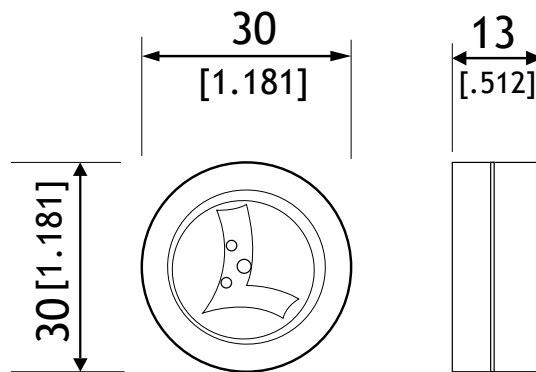

The products of LOYTEC electronics GmbH are subject to constant development. Therefore, LOYTEC reserves the right to modify technical specifications at any time without prior notice. The most recent datasheet can be downloaded from www.loytec.com.